

HY Pump

Instruction Manual



HONYA CO., LTD
www.reefoctopus.com



Dear Customer

Thank you for choosing Octo, a quality product manufactured by HONYA CO., LTD. In order for you to safely use our product for maximum results, please read this instruction prior to use. We would strongly suggest that you retain this Instruction for future reference.

Overview

- Exceptionally durable ceramic impeller made with Silicon Nitride to resist abrasion and lower operating temperature.
*HY-10000S, HY-10000W, HY-12500W, HY-16000W uses alloy.
- Uses Neodymium Magnet.
- Pump Body is manufacture with a mixture of high-grade PC+PET material. This material can be submerge long term in water without fatigue associated with regular plastic and is able to withstand ozone.
- Cooling chambers build within pump body to lower the operating temperature and thus enhance the pump longevity.
- Suitable for both Fresh and Marine water.
- Suitable for Wet or Dry operation.

Safety Tips

- Do not operate this pump without water flowing through. Overheating pump could potentially be a Fire Hazard.
- Do not operate this pump in water where debris (sand, mud, pebbles etc) are found, this will damage the impeller and short-circuit the pump.
- For Skimmer Pump, always operate with air intake open to prevent damage to the needle wheel impeller.
- Please do not carry the pump via the power cable only, this will cause the power cable to break.

Skimmer Pump Assembly

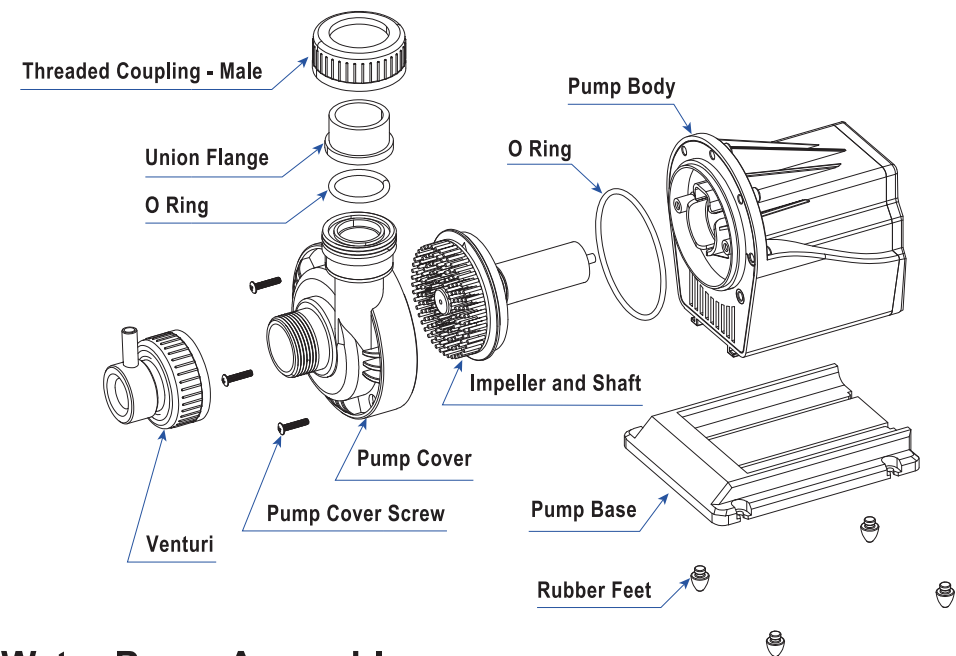

Water Pump Assembly

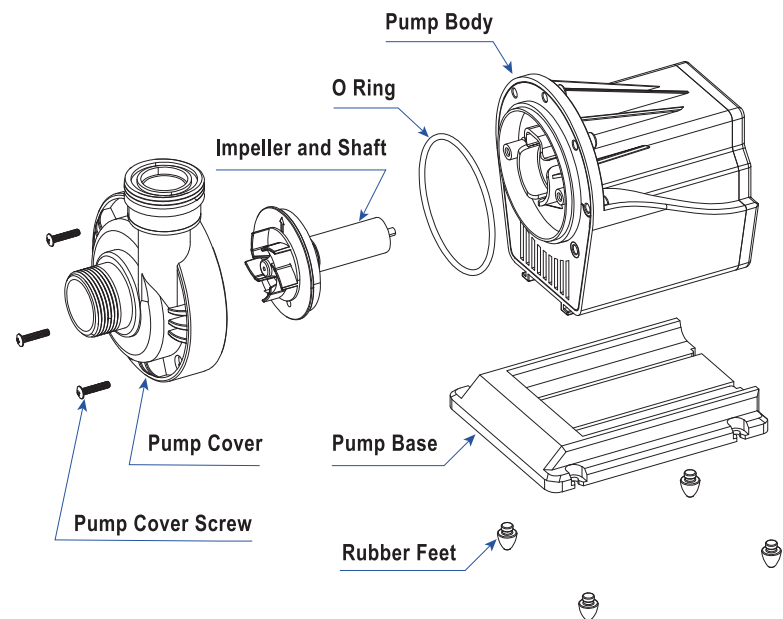



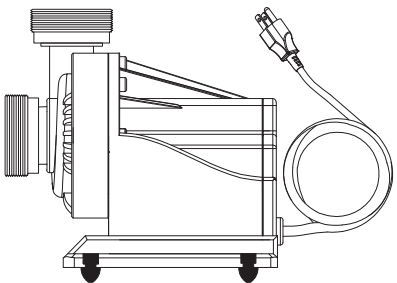

Package

Please check content in the package





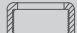
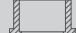



- Pump Body



- Skimmer Pump Accessories

					Model
1	1	1	1	1	HY-1000S
1	1	1	1	1	HY-2000S
1	1	1	1	1	HY-5000S
1	1	1	1	2	HY-10000S

- Water Pump Accessories

									Model
2	2	2	2	1	2			4	HY-1000W
2	2	2	2	1	2			4	HY-2000W
2	2	2	2	1	2			4	HY-3000W
2	2	2	2	1	2			4	HY-4000W
			2	1	2	2	2	4	HY-5000W
			2	1	2	2	2	4	HY-7000W
			1	1	2	2	2	4	HY-10000W
			1	1	2	2	2	4	HY-12500W
			1	1	2	2	2	4	HY-16000W

*above parts are listed not according to dimensions.

Size

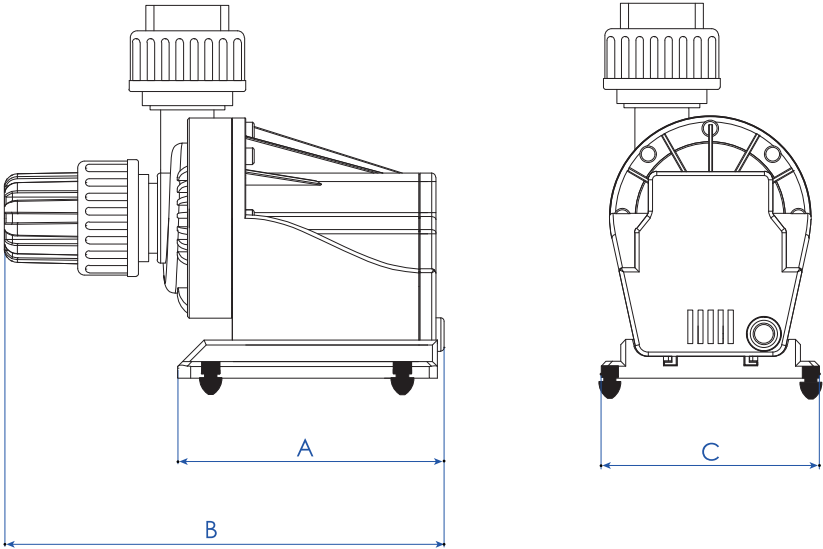

Model	Inlet Size		Outlet Size		A		B		C	
	mm	inch	mm	inch	mm	inch	mm	inch	mm	inch
HY-1000W	25	3/4	20	1/2	115	4.5	175	6.9	90	3.6
HY-2000W	25	3/4	20	1/2	115	4.5	175	6.9	90	3.6
HY-3000W	32	1	25	3/4	145	5.7	200	7.9	105	4.2
HY-4000W	32	1	25	3/4	145	5.7	200	7.9	105	4.4
HY-5000W	40	1-1/4	32	1	145	5.7	235	9.3	110	4.4
HY-7000W	40	1-1/4	32	1	145	5.7	235	9.3	110	4.4
HY-10000W	40	1-1/4	32	1	165	6.5	255	10.0	130	5.2
HY-12500W	40	1-1/4	40	1-1/4	165	6.5	255	10.0	130	5.2
HY-16000W	40	1-1/4	40	1-1/4	165	6.5	255	10.0	130	5.2

Skimmer Pump Specifications

Model	Voltage / HZ	Power	Air Intake		Flow Rate	
	V/HZ		LPH	GPH	LPH	GPH
HY-1000S	220-240/50	15	540	143	520	137
	120/60	20	644	170	568	150
HY-2000S	220-240/50	25	960	253	900	238
	120/60	30	1022	270	946	250
HY-3000S	220-240/50	30	1100	290	1550	409
	120/60	35	1136	300	1609	425
HY-5000S	220-240/50	40	2100	554	1700	449
	120/60	55	2385	630	1817	480
HY-10000S	220-240/50	100	4000	1056	3200	845
	120/60	125	4542	1200	3293	870

Water Pump Specifications

Model	Voltage / HZ	Power	Head Height		Flow Rate	
	V/HZ		m	Ft.	LPH	GPH
HY-1000W	220-240/50	13	1.4	4.6	1600	422
	120/60	13	1.4	4.6	1666	440
HY-2000W	220-240/50	18	1.8	6.0	2000	528
	120/60	18	1.8	6.0	2101	555
HY-3000W	220-240/50	30	2.3	7.5	3400	898
	120/60	35	2.6	8.5	3483	920
HY-4000W	220-240/50	40	2.7	8.9	4200	1109
	120/60	45	2.9	9.5	4599	1215
HY-5000W	220-240/50	55	3.3	10.8	5200	1373
	120/60	60	3.4	11.0	5489	1450
HY-7000W	220-240/50	70	3.6	11.8	6900	1822
	120/60	80	4.3	14.0	7382	1950
HY-10000W	220-240/50	95	4.3	14.0	10000	2640
	120/60	120	4.9	16.0	10221	2700
HY-12500W	220-240/50	165	4.8	15.7	12500	3300
	120/60	175	5.6	18.5	12492	3300
HY-16000W	220-240/50	200	5.1	16.7	15000	3960
	120/60	250	6.7	22.0	15596	4120

Pump Performance

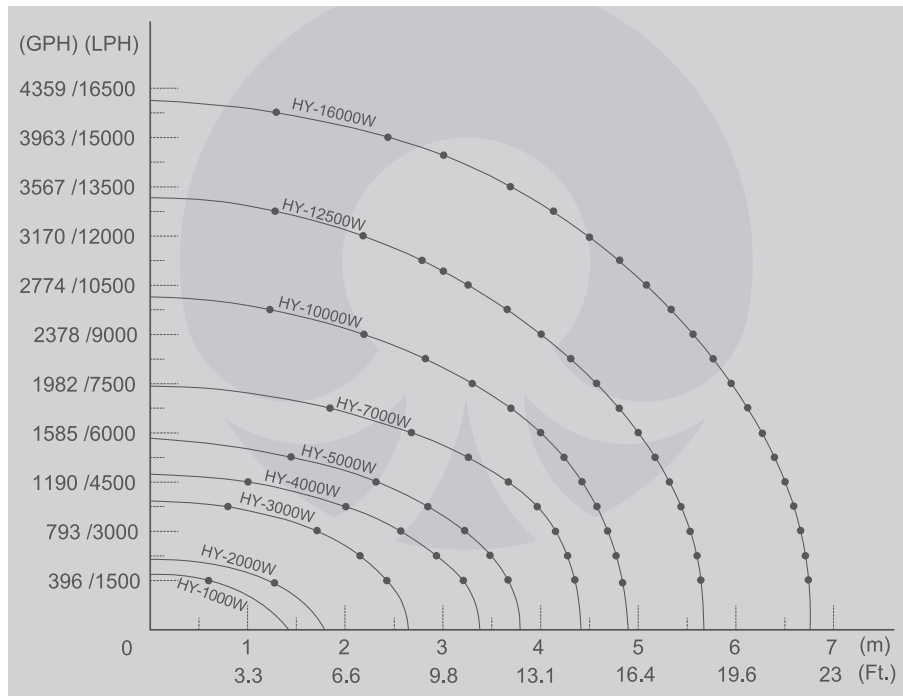

Maintenance

- For your safety, please ensure that this pump is plug into a power supply with earthing (grounding) connection.
- Please ensure that your pump is unplug before maintenance.
- Please ensure that both the power plug and your hands are dry before plugging in and turning on this pump.
- Warranty will be void if you attempt to extent or splice power cable or make any modifications to the pump.
- During operation, pump will be warm to touch, this is normal.

- Optimal operating water temperature between 0-35 °C .
- Do not operate and expose this pump to direct sunlight.

Trouble Shooting

Abnormal noise when pump is running.	Debris is trap inside pump chamber.	Off the pump, unplug the pump from power supply and remove debris from pump's chamber and impeller.
Pump not able to start/run.	<ol style="list-style-type: none"> 1. Larger debris could be trap inside the pump's chamber. 2. Impeller is stuck or not turning. 	Check the Impeller to ensure that it is not cracked or broken.
Plug in pump and the circuit breaker activated.	Electrical fault.	Disconnect the pump and contact our After Sales Service in your region.
Minimal flow or no flow.	<ol style="list-style-type: none"> 1. Intake is block, remove blockages. 2. Pump is not fully submerged in water. 	Check both water level and/or intake.
Abnormal or low air volume for Skimmer pump.	<ol style="list-style-type: none"> 1. Intake pipe is blocked or kinked. 2. Air Diffuser is blocked. 3. Misplaced Impeller. 4. Silencer is choked. 	Check all the above.
Abnormal vibrations.	Abnormal low power operations.	Ensure power supply grid is restore before plugging pump in.

Notes

[illegible]