

KS-100

Instruction Manual



OCTO Kalkwasser Auto Mix and Supply System

OCTO: KS-100

Thank you for purchasing OCTO KS-100, Kalkwasser Auto Mix and Supply System. This product is designed specifically to replace the hassle of dosing artificially calcium hydroxide manually into your aquarium. OCTO KS-100 will add calcium in a continuous process which will prevent sudden dramatic changes to the aquarium's environment.

OCTO KS-100 uses a motor which has a slow speed to rotate the mixing blades, preventing the contents from getting stratified. The dissolved calcium could then be added automatically and progressively into your aquarium.

We highly recommend using this product together with a timer. Turn it on for 5 minutes every 2 hours.

Component parts

OCTO KS-100 is built robustly and contains the following components as shown in the below picture.

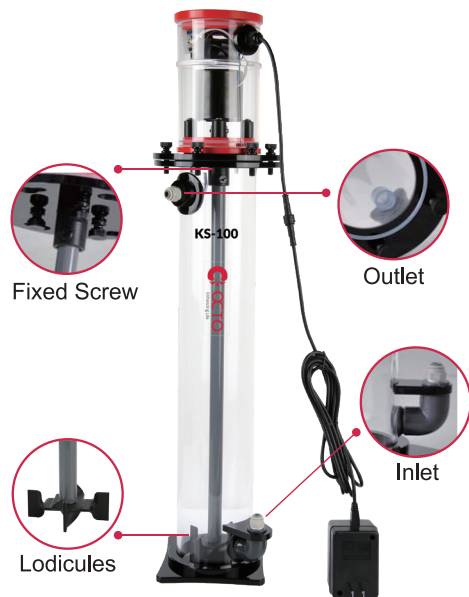

HOW TO USE THIS SYSTEM

1. ensure system is place in a upright and stable position.
2. connect the inlet and outlet tubes.
3. loosen the screws on the lid and remove the cover from the main body.
4. add about 90-120g calcium hydroxide and reverse step 3.
5. open inlet valve and add water into main body.
6. plug transformer into a timer and set the timer to turn on for 5 minutes every 2 hours.
7. adjust the inlet valve to an appropriate dosing rate suitable for your aquarium.



MAINTENANCE

Our motor is expected to run for 1500 hours, please ensure that you operate the system as per recommended.

SAFETY

- Ensure that the power transformer is plugged-in away from places where it will be expose to moisture or water.
- Always OFF the power supplies and unplugged from wall socket when adding calcium hydroxide or when maintaining the system.
- Handle the system with care, may break if drop from height.

TECHNICAL DATA

Voltage: Input, 220-240V; Output, AC24V
 Input, 120V; Output, AC24V
 Power consumption: ≤15 Watt
 Life time: 1500H (for motor)

WARRANTY

Please refer to the below URL:
<https://reefoctopus.com/services/warranty/>

HONYA CO., LTD
www.reefoctopus.com

KS-100

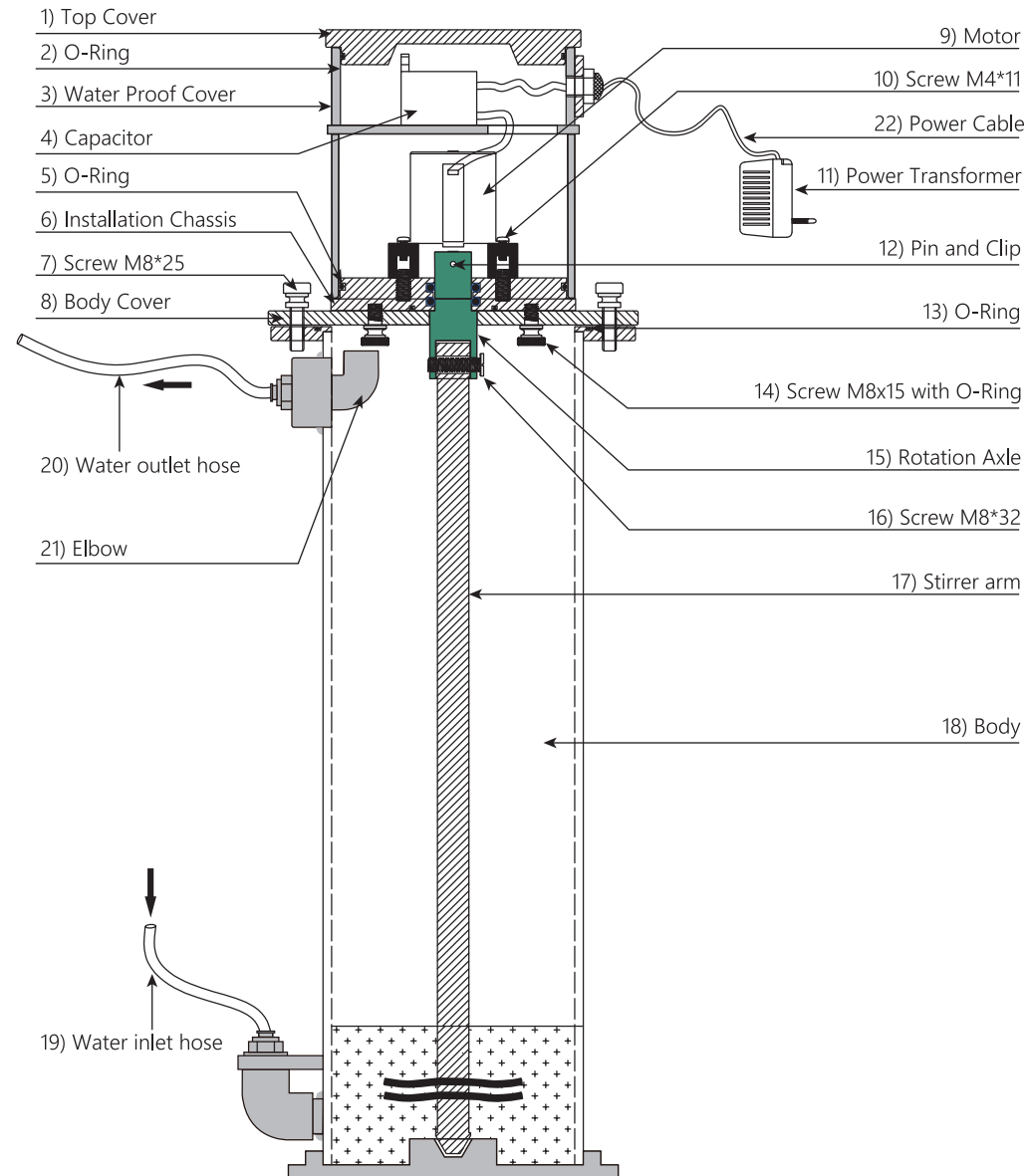

- 1) Top Cover
- 2) O-Ring
- 3) Water Proof Cover
- 4) Capacitor
- 5) O-Ring
- 6) Installation Chassis
- 7) Screw M8*25
- 8) Body Cover
- 9) Motor
- 10) Screw M4*11
- 11) Power Transformer
- 12) Pin and Clip
- 13) O-Ring
- 14) Screw M8x15 with O-Ring
- 15) Rotation Axle
- 16) Screw M8*32
- 17) Stirrer arm
- 18) Body
- 19) Water inlet hose
- 20) Water outlet hose
- 21) Elbow
- 22) Power Cable